



SERIES D1 DISCONNECT SWITCHES

25 Amp / 600 VOLT
also 16 Amp 600 VOLT

SERIES D1 MULTI- APPLICATION SWITCHES

- Machine Disconnect
 - Motor Switch
 - Bypass Switch
 - Step Switch
- Reversing Switch
- Two Speed Switch
- Ammeter Switch
- Voltmeter Switch

To 8 Pole, 8 Positions



ELEKTRA

ELEKTRA DISCONNECTS MACHINE SAFETY DISCONNECT OPTION FEATURING

- *HANDLE-SHAFT SELF-ALIGNING SYSTEM*
 - IP65 DUSTTIGHT / WATERTIGHT
METAL / NON-METAL ENCLOSURES
 - STEEL SHAFT
- HORSEPOWER RATED



Cal-Centron Wholesale Co.

3225 Tomahawk Dr.
Stockton, CA 95205

Voice: 800.252.2094 / 209.942.2094

Fax: 209.942.2163

E-mail: sales@calcentron.com

Web: www.calcentron.com

THE MULTI APPLICATION SWITCH!

SERIES D1 DISCONNECTS (ON-OFF)

25 Amp 600 VOLT



PADLOCKABLE

Lockout
Tagout



SAFETY DOOR

INTERLOCKS
Auto Alignment
Page D1-4



Non-Auto Alignment

Direct Drives
Page D1-4

Front Mount Disconnects



Page D1-4



Base Mount
Page D1-4

Enclosed Dust / Water Tight



Page D1-5



Fusible Open
Page D1-14



Fusible Enclosed
Page D1-5

DISCONNECTS
25 AMP

SERIES D1 SWITCHES

STEP SWITCH
Page D1-7



BYPASS
Page D1-8



METER
Page D1-7



SPRING RETURN
Page D1-9

KEY OPERATED
Page D1-6

Also Available: Disconnects
Series D2 through 7 to 250 Amp
Series D8, 9 to 630 Amp

◆CAM SWITCHES to 630 AMP
UP TO 12 POLES, 12 POSITIONS



UV TRIP
Series F and S
with UV Trip
(Under Voltage Trip)

BUILT TO CUSTOMER SPECS
See Bulletin VN 8

ENVIRONMENT RATINGS

"IP" Rating. Protection against ingress of dust and liquids.

OPERATOR HANDLES / ENCLOSURES IP65

1st Digit
6

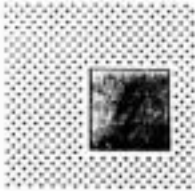

Complete protection against dust.

2nd Digit
5



Protected against water sprayed from a hose from all directions.

(See IP standard for exact specifications)

NEMA/IP65

IP65 is for Industrial and Outdoor Applications and is capable of hose test water tightness.

IP65 is used internationally for similar applications as Type 4, or 4X for non-corrosive design areas.

ELECTRICAL RATINGS

SWITCH SIZE D1		
Rated interrupted current iu switch	A	25
Approvals Canada, USA, UL	600 VAC max., 3 phase -A	
General Use	IEC/UL/CSA	25A
Motor 1 phase		Motor 3 phase
120V	1 hp	208V 5 hp
240V	2 hp	240V 5 hp
		480V 7.5 hp
		600V 7.5 hp
Pilot Duty-Auxiliary switch UL/CSA	A600	
INTERNATIONAL RATINGS CE		
IEC 204, IEC 947-3, EN60204, EN 60947, VDE 0113		
Rated insulating voltage III/3 EN 60 947 UI	V	600
Rated impulse voltage rigidity III/3 EN 60 947	kV	6
Connectable cross section	mm ²	1-4
	AWG	14-10
Short-circuit protection fusible cut-out (gL)	A max.	35
Switching capacity AC-21A/B Load break switches		
Rated operating 25 Amp	VAC	690
AC-23 A/B Motor Switches	380/440V	7.5KW

DISCONNECTS 25 AMP

DISCONNECT SAFETY STANDARDS & REQUIREMENTS

NFPA (Also per ANSI and NEC)

13.2 Emergency stop devices

13.2.3 Actuators of emergency stop devices shall be colored RED.

As far as a background exists behind the device actuator, it shall be colored YELLOW.

OSHA LOCKOUT-TAGOUT

While the OSHA Lock Out-Tag Out requirement is commonly understood, color is also specified. **1910.144 Safety color code for marking physical hazards.**

(ii)...Electrical switches which letters or other markings appear, used for emergency stopping of machinery shall be RED.

INTERNATIONAL SPECIFICATIONS.

IEC 204, IEC947-3 IEC...EN, EUROPEAN NORM. EN 60 204 PART 1 EN 60 947



The VDE specifications 0113 part 1 apply to the electrical equipment of machines. They comply largely with the IEC publication 204. This standard includes the German version of the European standard EN 60 204 part 1: 1992.

▲ Emergency-off switch

Emergency-off mechanisms must be provided for each work station, where an emergency-off might be required. They must engage automatically and be easy to reach.

☞ The contacts of hand-operated emergency-off mechanisms shall disconnect simultaneously.

☞ The operating elements shall be RED. The area behind the handles shall be colored YELLOW.

▲ Main switch = Emergency-off switch

For some machines which do not require emergency-off mechanisms the main switch may function as an emergency-off mechanism.

☞ In this case and for such disconnecting mechanisms the colors of the operating elements have to be the same as for the emergency-off mechanisms.

▲ Main Switch

Each power supply must be provided with a hand-operated main switch. This main switch must disconnect the machine from the power supply (e.g. for machine maintenance).

☞ It shall be designed as a switch-disconnector according to EN 60 947-3 to satisfy the exigencies of utilization category AC-23B.

☞ It shall be hand-operated and may have only one "off" and one "on" position.

☞ It shall have a visible isolation section or indication of switching position which can indicate the "off" position only if spacings according to EN 60 947-3 have been obtained between all contacts.

☞ **If the main switch will not be used simultaneously as emergency-off switch, it's handle shall NOT be red. For the main switch black or grey handles are recommended.**

☞ It shall be lockable in the "off" position (e.g. by using padlocks).

☞ The handle of the main switch shall be easy to reach and located between 0.6 and 1.9m above the access level.

☞ The breaking ability must be sufficient to break at the same time the current of the largest motor of the machine at stall and the sum of the currents of all other motors and / or load circuits.

TYPE D1 25 AMP OPEN TYPE - ("OFF-ON")

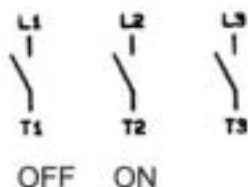

Type BE Handle Shown

WITH SAFETY DOOR INTERLOCK ▲

Number Poles	AMP	Auto Align Style Catalog No.	LIST PRICE	Direct Drive "V" Catalog No.	LIST PRICE
2	25	E D 1-2BE 1 SD8-*	\$56.00	E D1-2BE 1 SD V8-*	\$50.00
3	25	E D 1-3BE 1 SD8-*	\$66.00	E D1-3BE 1 SD V8-*	\$60.00
4	25	E D 1-4BE 1 SD8-*	\$69.00	E D1-4BE 1 SD V8-*	\$63.00
5	25	E D 1-5BE 1 SD8-*	\$78.00	E D1-5BE 1 SD V8-*	\$72.00
6	25	E D 1-6BE 1 SD8-*	\$86.00	E D1-6BE 1 SD V8-*	\$80.00

Type BE Operator usable with one padlock.
For Type D Operator, useable with 3 padlocks, in catalog number, replace "BE" with "D".
Add \$7.00 List.



BASE MOUNT OPERATOR

Catalog No.	LIST PRICE
E D1-2BE 1 BM-*	\$38.00
E D1-3BE 1 BM-*	\$48.00
E D1-4BE 1 BM-*	\$56.00
E D1-5BE 1 BM-*	\$64.00
E D1-6BE 1 BM-*	\$72.00

Base Mount units mount on Dinrail or Screw mount. Operator and ON-OFF plate are fixed to switch housing.



TYPE D1 25 AMP - OPEN TYPE
FRONT MOUNT ("ON-OFF")

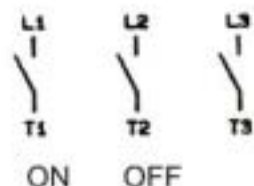

Type D Operator

▲ SHAFT EXTENSION

Switch shaft length is designed for a typical 8" deep enclosure. Check factory or cut shaft for shorter shaft lengths.

Shaft Extension 200mm (7.87")
Catalog No. ED-SE-5.....\$15.00 List
Suitable for switch series D1, D2, or D3.
SHAFT COUPLING ONLY
Catalog No. E-171479....\$4.00 List

Type BY-1 Operator Handle Option

To order, add BY in place of BE in catalog number. Add \$10 list. Includes safety door interlock.

TYPE BY-1 - Door interlock can be bypassed by qualified technician for servicing.

Recommended for (Type 1,3R,12,4X) applications.

To order BY-1 separately, see page D1-9.

(Available in Red/Yellow Color Operator or Black on Black).



Number Poles	AMP	Two Drilling Mount Catalog No.	LIST PRICE	Single Hole Mount 22mm (7/8") ◆	LIST PRICE
2	25	E D1-2BE 1 FM-*	\$35.00	E D1-2BE 1 SH-*	\$40.00
3	25	E D1-3BE 1 FM-*	\$45.00	E D1-3BE 1 SH-*	\$50.00
4	25	E D1-4BE 1 FM-*	\$48.00	E D1-4BE 1 SH-*	\$53.00
5	25	E D1-5BE 1 FM-*	\$57.00	E D1-5BE 1 SH-*	\$62.00
6	25	E D1-6BE 1 FM-*	\$65.00	E D1-6BE 1 SH-*	\$70.00

◆ Adapter Ring for 30mm mount

To convert standard 22mm mount switch (7/8" mounting) to full size 30.5mm.
#ED-134353 \$0.80 list each.

* SUFFIX:

Add - RG for Red-Yellow operator handle
Add - SS for Black handle "D" type only.
Add - SI for Black-Silver operator "BE"

DISCONNECTS
25 AMP

**TYPE D1 25 AMP ENCLOSED
NON FUSIBLE TYPE ON-OFF**

25 Amp 600 Volt

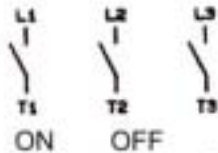

DISCONNECTS
25 AMP

Number Poles	AMP	NON METAL IP65 S4		NON METAL NEMA 4X		METAL IP65	
		NON FUSED ON-OFF	List Price ▲	NON FUSED ON-OFF	List Price	NON FUSED ON-OFF	List Price
2	25	E D1-2BE-S4-*	\$68.00	E D1-2D-4X-*	\$123.00	E D1-2D-M65-*	\$91.00
3	25	E D1-3BE-S4-*	\$78.00	E D1-3D-4X-*	\$133.00	E D1-3D-M65-*	\$101.00
4	25	E D1-4BE-S4-*	\$81.00	E D1-4D-4X-*	\$136.00	E D1-4D-M65-*	\$104.00
5	25	E D1-5BE-S4-*	\$90.00	E D1-5D-4X-*	\$145.00	E D1-5D-M65-*	\$113.00
6	25	E D1-6BE-S4-*	\$98.00	E D1-6D-4X-*	\$153.00	E D1-6D-M65-*	\$121.00

ENCLOSURES. Each of the above D1 enclosures is rated IP65 dust tight / water tight / hose test. IP65 is for industrial and outdoor applications and is capable of hose test water tightness. IP65 is used internationally for similar applications as the NEMA 4 or 4X, when non-corrosive design is required.

▲ Above are T8 Enclosures. For compact T24 Enclosure, add suffix -T24. Deduct -\$10 List

OPERATOR HANDLE

*SUFFIX:

- Add -RG for Red-Yellow operator Handle.
- Add -SS for Black handle "D" type only.
- Add -SI for Black-Silver operator "BE" handle.

"NEW PRODUCTS"

Padlockable Fusible ENCLOSED TYPE



MINI COMPACT 4X



NEMA 4X



NEMA 3R



NEMA 12

600 VOLT		NEMA 3R		NEMA 12		NEMA 4X	
FUSE BLOCK AMP/TYPE	SWITCH AMPS/TYPE	CATALOG#	LIST	CATALOG#	LIST	CATALOG#	LIST
30 / CC	40 / ED2	ED2-D-FC3-3R-RG	\$360	ED2-D-FC3-12-RG	\$380	ED2-D-FC3-4X-RG	\$380
30 / J	40 / ED2	ED2-D-FJ3-3R-RG	380	ED2-D-FJ3-12-RG	460	ED2-D-FJ3-4X-RG	460
60 / J	40 / ED2	ED2-D-FJ6-3R-RG	395	ED2-D-FJ6-12-RG	475	ED2-D-FJ6-4X-RG	475
60 / J	80 / EDK4	EDK-D-FJ6-3R-RG	480	EDK-D-FJ6-12-RG	520	EDK-D-FJ6-4X-RG	520
100 / J	125 / ED5	ED5-D-FJ1-3R-RG	720	ED5-D-FJ1-12-RG	850	ED5-D-FJ1-4X-RG	850

Notes to Enclosed Type Fusible Disconnects.
Above enclosed units are Standard "D" operators. Red / Yellow. If Black desired, replace RG with SS.

For "Finger Safe" Designs add suffix - FS (Add \$24 List)
For additional Accessories Contact Factory.

REVERSING (Maintained)

25 Amp 1 Phase / 3 Phase



REVERSING (Spring to Center) Same Circuit as maintained.



Catalog Number (**)	-*Suffix		
	Open -SO	Enclosed -S4 ▲	Enclosed -M65
ED1-3KW 1FM-*	\$64	\$87	\$107

Wiring Standard circuit is 3 phase. For Single Phase Reversing, add one jumper per EEC Diagram. For factory supplied 1 Phase unit, change catalog number **3W** to **1W**. No price change.

Horse Power Rated		Horse Power Rated	
1 Phase		3 Phase	
120V	1HP	240V	5 HP
240V	2HP	480V	7.5HP
		600V	7.5HP

Catalog Number (**)	-*Suffix		
	Open -SO	Enclosed -S4 ▲	Enclosed -M65
ED1-3W 1FM-*	\$57	\$80	\$99
ED1-3W 1BM-*	\$59	-	-

(**) Marking on above is "FOR OFF REV". Front Mount, FM or Base Mount, BM.

For other standard Name Plate marking, see **Ledgend Plate Marking** on Dimension Page.

▲ Above S4 Enclosure is T25 (see dimension page). For larger T8 Enclosure, add suffix -T8, plus \$6.00 list.

TWO SPEED MOTOR SWITCHES

TWO SPEED: CONSTANT OR VARIABLE TORQUE 3 PHASE										
Max Horsepower		Catalog No.	Single Winding (1-0-2)				Two Winding (0-1-2)			
230V	460V		Open Front Panel Mount	List	S4 Enclosed	List	Open Front Panel Mount	List	S4 Enclosed	List
3	7.5	ED1-4PT 1FM-	-SO	\$86	-S4	\$109	-	-	-	-
3	7.5	ED1-3PT 1FM-	-	-	-	-	-SO	\$69	-S4	\$92

TWO SPEED: CONSTANT HORSEPOWER 3 PHASE										
Max Horsepower		Catalog No.	Single Winding (1-0-2)				Two Winding (0-1-2)			
230V	460V		Open Front Panel Mount	List	S4 Enclosed	List	Open Front Panel Mount	List	S4 Enclosed	List
2	5	ED1-4PH 1FM-	-SO	\$86	-S4	\$109	-	-	-	-
2	5	ED1-3PH 1FM-	-	-	-	-	-SO	\$69	-S4	\$92

Standard marking on above (1-0-2) is "LOW-OFF-HIGH"

Standard marking on above (0-1-2) is "OFF-LOW-HIGH"

For **METAL ENCLOSURE**, IP65, add suffix: **-M65**, to above part #'s, plus \$17.00 list.

KEY OPERATED ON-OFF 25 Amp

No. Poles	Catalog Number	-*Suffix		
		Open -SO	Enclosed -S4 ▲	Enclosed -M65
1	ED1-1ZE 1FM-	\$75	\$108	\$131
2	ED1-2ZE 1FM-	\$78	\$111	\$134
3	ED1-3ZE 1FM-	\$88	\$121	\$144
4	ED1-4ZE 1FM-	\$91	\$124	\$147



Note: Open type units are 2 or 4 screw mount as standard.

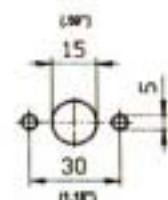

DISCONNECTS 25 AMP

STEP SWITCH with "OFF" position

OPEN TYPE FRONT PANEL MOUNT 25 Amp

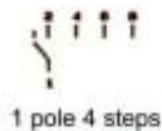
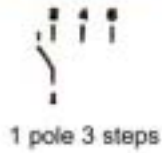

No. Steps	Catalog No.	List Each	No. Chambers
1	ED1-1SO 1 FM-SO	\$32.00	1
2	ED1-2SO 1 FM-SO	\$35.00	1
3	ED1-3SO 1 FM-SO	\$45.00	2
4	ED1-4SO 1 FM-SO	\$48.00	2

STEP SWITCH without "OFF" position

OPEN TYPE FRONT PANEL MOUNT

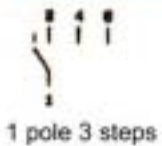

No. Steps	Catalog No.	List Each	No. Chambers
2	ED1-2S 1 FM-SO	\$35.00	1
3	ED1-3S 1 FM-SO	\$45.00	2
4	ED1-4S 1 FM-SO	\$48.00	2
5	ED1-5S 1 FM-SO	\$57.00	3
6	ED1-6S 1 FM-SO	\$60.00	3

NOTE: Above units are 2 or 4 screw mount as standard.



NOTE: For Single hole mount To order single hole mount: replace "FM" with "SH". Add \$5 List.

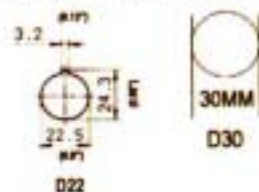

METER SWITCHES 25 Amp

OPEN TYPE FRONT PANEL MOUNT

VOLTMETER 3 PHASE

Line to Line



Catalog No.	List Each	No. Chambers
E D1-2V 1 FM-SO	\$48.00	2

VOLTMETER 3 PHASE

Line to Line - plus line to neutral

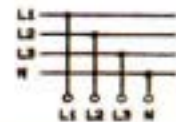

Catalog No.	List Each	No. Chambers
E D1-3V 1 FM-SO	\$80.00	4

AMMETER 3 PHASE

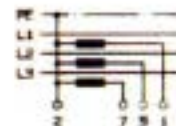

Catalog No.	List Each	No. Chambers
E D1-1MA 1 FM-SO	\$65.00	3

For other Meter Switch Circuits, see Catalog V2N. For S4 boxes, add \$23.00 to the open type.

DISCONNECTS 25 AMP

DISCONNECTS
25 AMP

BYPASS SWITCH *with* "OFF" Position

(Change-over switch) **Front Mount**

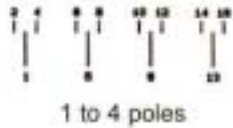

No. Poles	Catalog No.	List Each	No. Chambers
1	ED1-1U 1 FM-SO	\$45.00	1
2	ED1-2U 1 FM-SO	\$55.00	2
3	ED1-3U 1 FM-SO	\$65.00	3
4	ED1-4U 1 FM-SO	\$82.00	4

BYPASS SWITCH *with* "OFF" Position

(Change-over switch) **Base Mount**

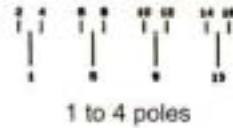

No. Poles	Catalog No.	List Each	No. Chambers
1	ED1-1U 1 BM-SO	\$49.00	1
2	ED1-2U 1 BM-SO	\$59.00	2
3	ED1-3U 1 BM-SO	\$69.00	3
4	ED1-4U 1 BM-SO	\$86.00	4

Above units are marked "1 0 2"

To supply above units with "Hand Off Auto" Legend Plate, Add **-K** to the end of the part number at no additional cost.

Ex: ED1-3U 1BM-SO-**K**

BYPASS SWITCH *without* "OFF" Position

(Change-over switch) **Front Mount**
Open Type

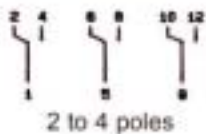

No. Poles	Catalog No.	List Each	No. Chambers
2	ED1-2UD 1FM-SO	\$55.00	2
3	ED1-3UD 1FM-SO	\$65.00	3
4	ED1-4UD 1FM-SO	\$82.00	4

BYPASS SWITCH *without* "OFF" Position

(Change-over switch) **Base Mount**
Open Type

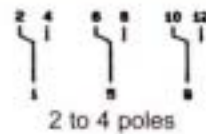

No. Poles	Catalog No.	List Each	No. Chambers
2	ED1-2UD 1 BM-SO	\$59.00	2
3	ED1-3UD 1 BM-SO	\$69.00	3
4	ED1-4UD 1 BM-SO	\$86.00	4

Base Mount units are suitable for DIN RAIL or screw mount.

*See page D1-11 for other available for other engravings.

**PRESSURE WASHER
25 / 40 / 60 AMP**



**LIFT SWITCHES
25 / 40 / 60 AMP
BOATS & HOISTS**



Type R Handle (see page D1-6)

DISCONNECTS
25 AMP

**INVERTER BYPASS
SWITCHES
25 AMP TO 630 AMP**



**SPRING RETURN
25 AMP**



SWITCH OPERATORS



E B-S1 E D-RG- E BE-RG- E BY-1-RG
 E D-SS- E BE-SI-

Operators Only	List
E B-S1*	\$ 7.00
E BE-RG*	\$16.00
E BE-SI*	\$16.00
E D-RG*	\$23.00
E D-SS*	\$23.00
E BY-1-RG*	\$35.00
E BY-1-SS*	\$35.00

Color Code
RG
Red-Yellow

B, SI, SS
Black-Silver

PIN Example:
E BE-RG-SI
Operator for
Type D Switch

Type BY (Includes Misalign feature
module & stem)

* Select Switch Size:
Switch Size *
D1, D2, D3 S1
D4, D5 S2
 S3

ELEKTRA PART NUMBERING SYSTEM

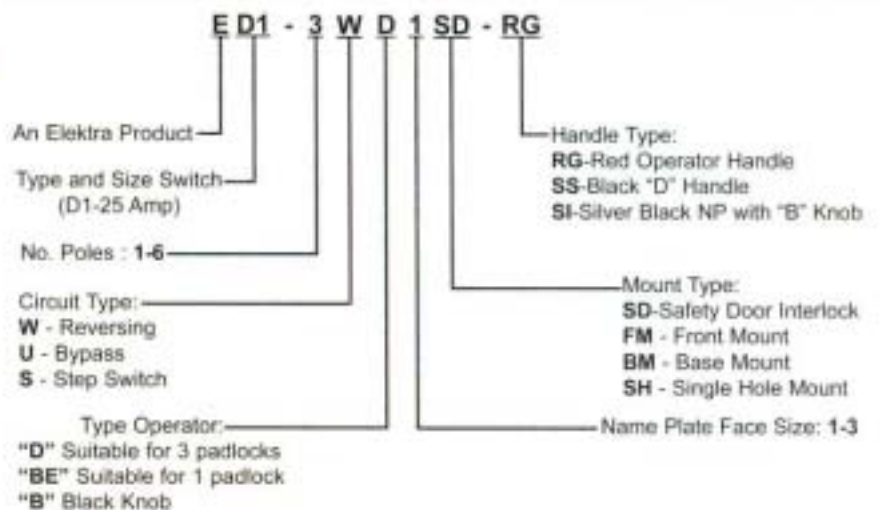

DIMENSIONS for D1 Mounting (Open Type)

Approx. Dimensions in mm (inches)

FRONT MOUNT

#Chambers	L
1	36 (1.4")
2	47 (1.9")
3	59 (2.3")
4	71 (2.8")

2 Contacts per chamber

Switch insert

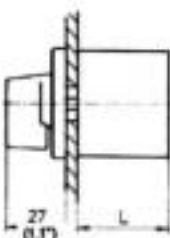

X max (0.16") 4mm

Front View

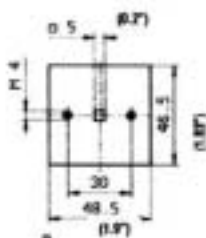

Face plate



Two M4 screws are supplied with Front Mount units to mount into inbedded nuts.

Panel drilling

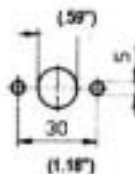

DISCONNECTS
25 AMP

OTHER MOUNTING OPTIONS FRONT MOUNT

Universal mounting is standard. The D1 front mount includes drilling pattern for 4 optional drillings, a, b, c, and d.

Front View

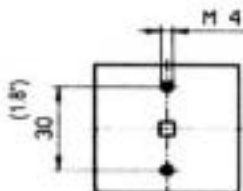

b.

Front View

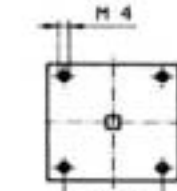

c.

Front View

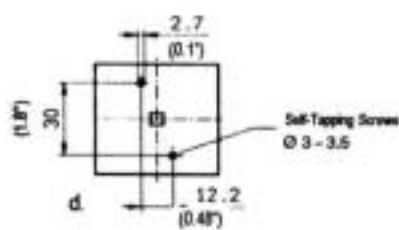

SINGLE HOLE MOUNTING

#Chambers	L
1	51 (2.0")
2	63 (2.5")
3	74 (2.9")
4	86 (3.4")

Switch insert

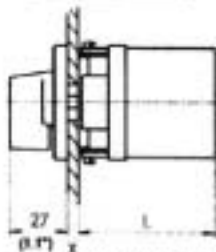

X max (0.16") 4mm

Front View



Face plate

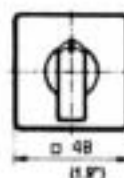

Panel drilling

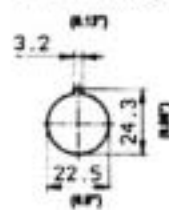

D1 BASE MOUNT WITH (SD) SAFETY DOOR INTERLOCK

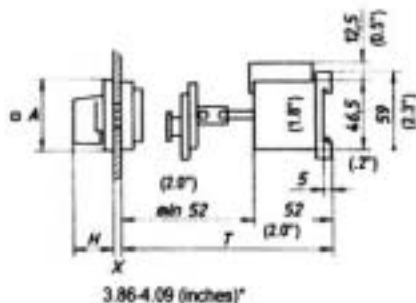

*Option for 8" deep enclosure, SD8, T=8"

Front View

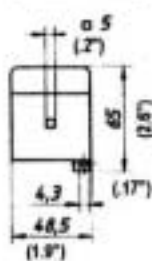

Panel drilling

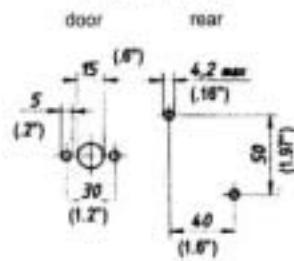

SERIES D1 DIMENSIONS, Appro. (Enclosed Type)

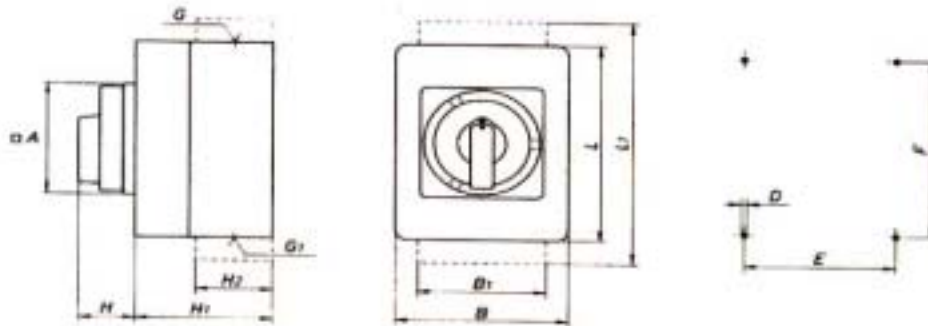

Enclosure/Type	Max Poles	B	L	HI	A	H	E	F	D	G	GI
G32 (Metal)	6 poles max	91mm 3.58"	97mm 3.82"	72mm 2.83"	43mm 1.69"	26mm 1.02"	79mm 3.11"	83mm 3.27"	5.5mm .22"	2x23mm 1.3" opening	2x23mm 1.3" opening
T24 (Non-Metal) Standard Compact	6 poles max	82mm 3.22"	82mm 3.22"	67mm 2.63"	65mm 2.56"	34mm 1.33"	68mm 2.67"	68mm 2.67"	4.5mm .17"	2xPG16	2xPG16
T25 (Non-Metal) Standard	8 poles max	82mm 3.22"	82mm 3.22"	93mm 3.66"	65mm 2.56"	34mm 1.33"	68mm 2.67"	68mm 2.67"	4.5mm .17"	2xPG16	2xPG16
T8/1 (Non-Metal)	6 poles max	91mm 3.58"	121mm 4.75"	75mm 2.94"	72mm 2.83"	34mm 1.33"	76mm 2.98"	106mm 4.16"	4.5mm .17"	2xPG16	2xPG16

Each D1 chamber section contains 2 poles. *PG16 accepts 7/8" cord grip

NOTE: Plastic Enclosures supplied with 3 plugs and 1 conduit adapter, threaded.

Metal Enclosures supplied with 2 plugs and 2 open non-threaded holes.

LEGEND PLATE TYPE SI MARKING

Standard markings

Identification Suffix

OFF ON	-N
HAND OFF AUTO	-K
FOR OFF REV	-I
UP OFF DOWN	-J
MANUAL AUTO	-L
HIGH OFF LOW	-P

Check with factory for additional standard markings.

Special Marking Legend add: \$6.80 List

PLATE SI

Silver with

Engraved Black Letters

FACE SIZE	DIMENSIONS
1	1 7/8"x1 7/8" (48mm)
2	2 1/2"x2 1/2" (65mm)
3	2 7/8"x2 7/8" (72mm)

NAME PLATE MARKING

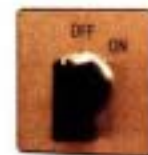

Face Size 1



Face Size 2

Disconnect Inscription Plate			List Price	
Fits above Type BE, BY, D, SI Operator/Plates		Catalog#	48 x 16mm (1.9"x0.6")	65 x 16mm (2.5"x0.8")
Main Switch	Brush Silver with black letters	ED-NP-S1	\$5	\$6
	Yellow with black letters	ED-NP-Y1	\$5	\$6
Main Switch	Black with white letters	ED-NP-B1	\$5	\$6

MAIN SWITCH

Standard marking add suffix: Main switch (-MS) or Emergency Off (-EO)

For special marking add \$6 List Example: #ED-NP-S1

DISCONNECTS 35 AMP

THE MULTI APPLICATION SWITCH!

SERIES D1 SWITCHES

25 Amp 600 Volt



TYPE "B" KNOB

OPEN TYPE "B" KNOB
FRONT PANEL MOUNT
ALL IP65 OPERATORS

DUST TIGHT
HOSE TEST WATER TIGHT



SPRING RETURN
OPTIONS

DESIGN: LOAD MAKE - LOAD BREAK (POSITIVE BREAK)

Extra contact force on each pole insures reliable continuity on every operation. Full 25 Amp rating insures contact fidelity.

STEEL SHAFT STANDARD

UNIVERSAL MOUNTING

Flexible mounting options:

Include 2 screws or single hole, 22m (7/8")/30mm



Type B Knob
(Silver Plate SI shown can be engraved to suit)



Type BE Operator
(Locks OFF one padlock. 3 padlock off also available).



Suffix - S4
Nonmetal
ENCLOSED



Suffix - M65
Metal
ENCLOSED



Universal Mounting
Matches most
all designs
(see dimension page)



- ◆ Reversing Switch
- ◆ Two Speed Switch

SERIES D1
IDEAL AS:

- ◆ MACHINE DISCONNECT
- ◆ MOTOR SWITCH
- ◆ BYPASS SWITCH
- ◆ STEP SWITCH
- ◆ SPRING RETURN

OTHER COMPACT DISCONNECTS

See catalog ET...Series D2 through D7
for higher current ratings through 250
Amp, 600 Volt, 100hp.



TYPE D7 (250Amp)